



A New Martinsville – Henry County YMCA

FACILITY STRATEGY & DESIGN

YMCA
June 2023

gro>



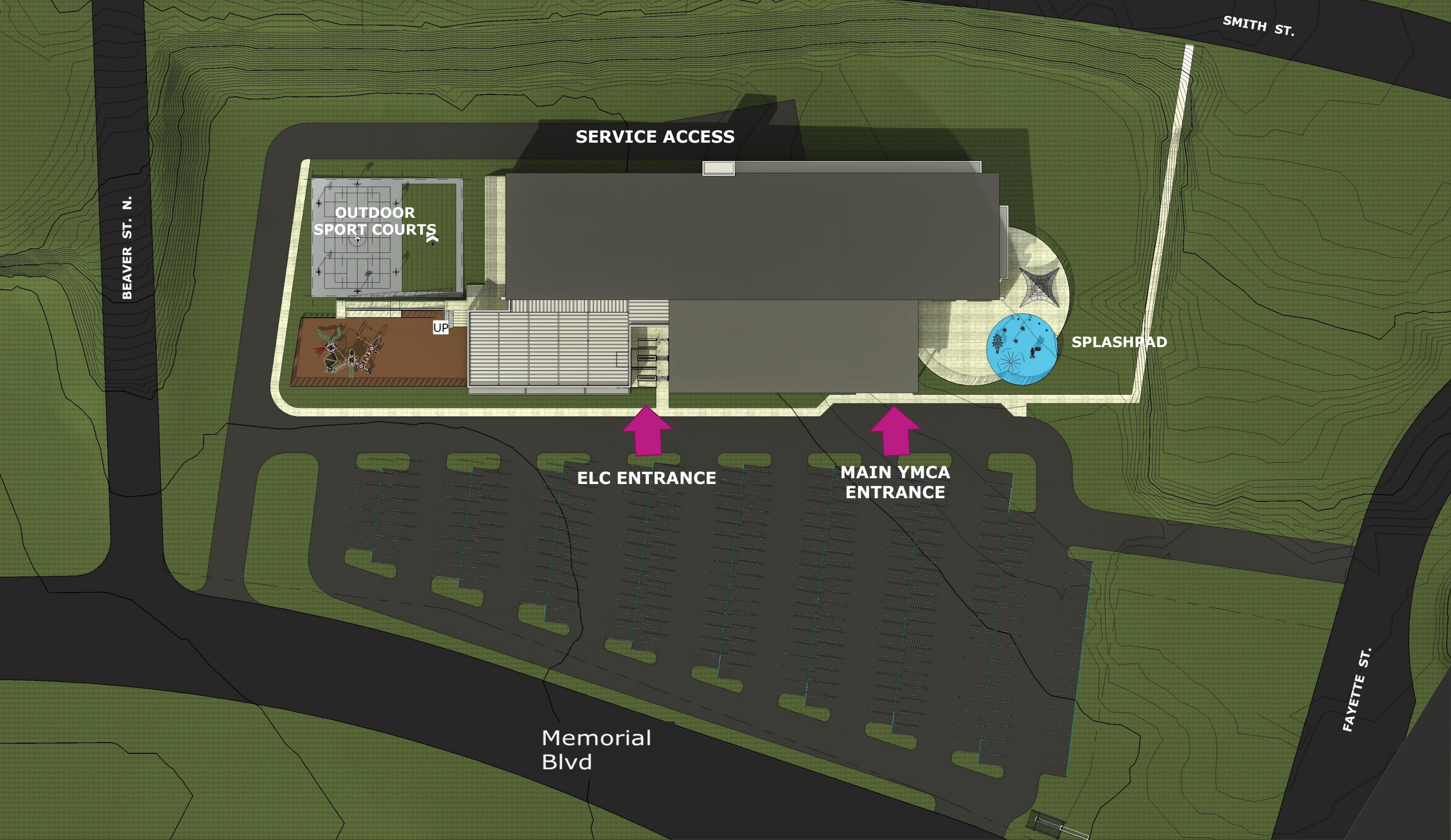







EARLY LEARNING CENTER



OUTDOOR COURTS & PLAYGROUND

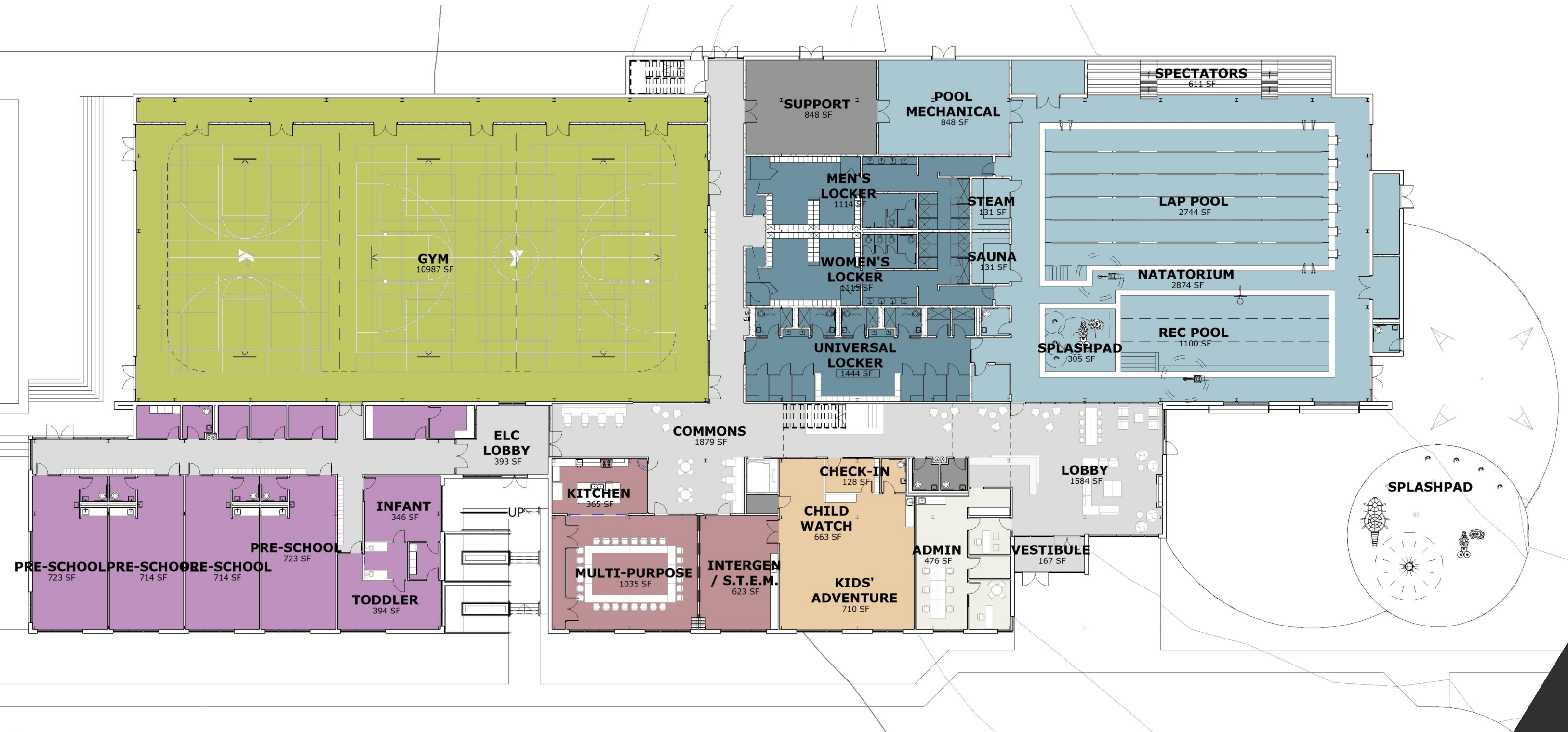

FIRST FLOOR PLAN







COMMUNITY

Community Multipurpose Rooms

450 SF & 750 SF; 80 occupants

Multipurpose Community Rooms for community meetings, education, gathering, and education.

Ability to be combined (1,200 sf total) for Y activities. Also can be combined with Intergeren for 1,950 sf total (130 occupants)



COMMUNITY

S.T.E.A.M. Lab

1,100 SF; 31 occupants

Specialty room with an emphasis on education, arts, and exploration for children over the age of 10 years.

Part of the exploration suite of venues.



COMMUNITY

Community Kitchen

400 sf; 15 occupants

Community Kitchen for cooking classes, nutrition consulting, catering events, and open programming

Residential appliances with an emphasis on flexible programming and usage.



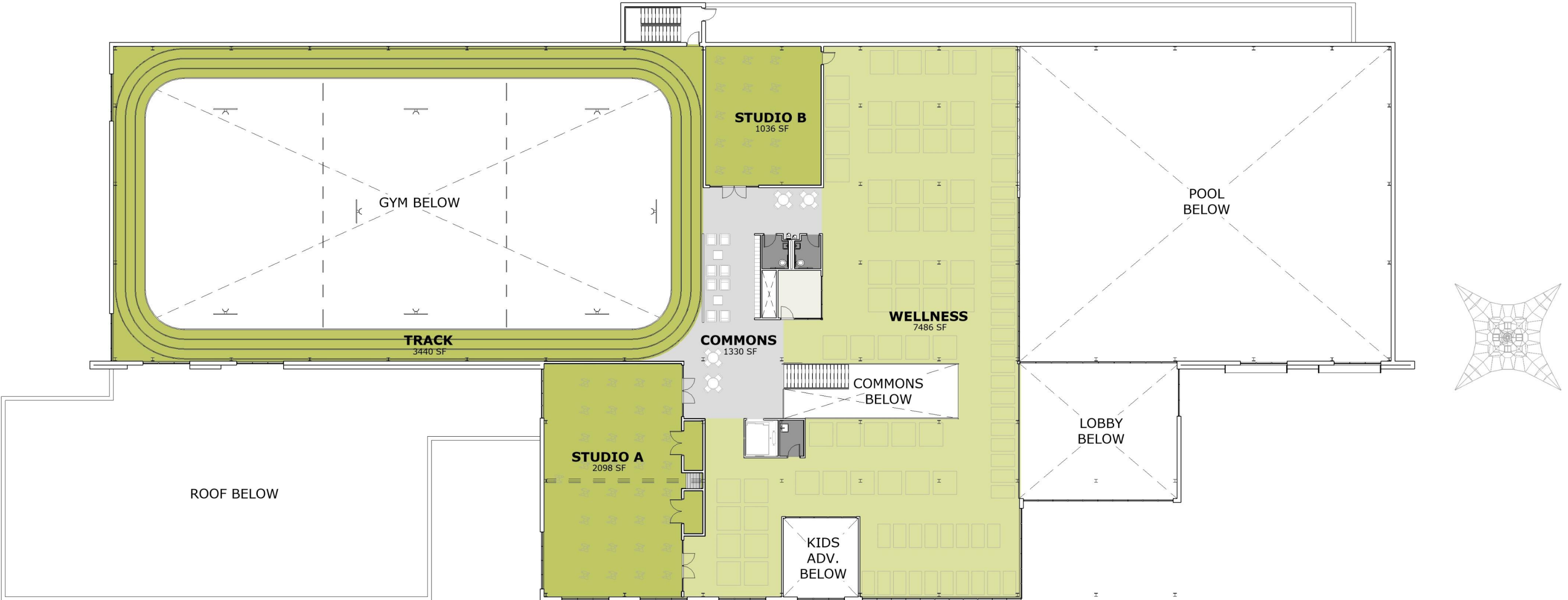

SECOND FLOOR PLAN



WELLNESS

MP Studio "A" - General

Fitness Studio with a focus on aerobics, dance, and high intensity group exercise classes



WELLNESS

MP Studio "B" – Mind/Body

Fitness Studio with a focus on mind/body classes: Yoga, Tai Chi, Barre, Meditation, etc.

Calming/quiet environment.





WELLNESS

Wellness Center

Fitness Center for exercise and healthy living.

Includes cardio, selectorized equipment, free weights, core/stretching, and functional training.





A New Martinsville – Henry County YMCA

Membership by the numbers

3,269 memberships- 5,634 members

294 or 12% receive financial assistance

1,750 or 53% paid for by 3rd party

275 or 8% partial or full pay by employer

950 or 29% pay regular rate